

DEALER PRICE LIST EFFECTIVE JANUARY 1, 2009

ITEM	PRODUCT DESCRIPTION	LIST (each)
------	---------------------	-------------



**AA**

**Model AA / 115V-60Hz Upright Glass Washer**

\$581.80

Heavy duty stainless steel construction. Four 7" brushes and one 8" center brush, 1/3h.p. motor. 17.75" tall, 8" wide, 12" deep, 27 lbs shipping weight. Carton size: 16" x 11" x 19.5"

- With Ground Fault Protection
- In 220v, 50/60h

MADE IN THE USA



Conforms to UL STD 92; NSF STD C-2  
 Certified to CAN/CSA C22.2 STD NO. 188

631.40  
 629.90



**AA-SUB**

**Model AA-SUB / 115V-60Hz Submersible Glass Washer**

\$742.80

Heavy duty stainless steel construction. Four 7" brushes and one 8" center brush, 1/3 h.p. motor with automatic overload safety and Ground Fault Protection plug.

11" tall, 8" wide, 12" deep, 27 lbs shipping weight. Carton size: 16" x 11" x 13.5"

- With 220-230V - 50/60hz, G.F.I not available

MADE IN THE USA



Conforms to UL STD 92; NSF STD C-2  
 Certified to CAN/CSA C22.2 STD NO. 188

\$796.90



**Universal Replacement Brushes and Manual Post Brushes**

<b>B7</b> - 7" x 3" overall size Brush for glasses up to 6" deep	\$16.80
<b>B8</b> - 8" x 3" overall size Brush for glasses up to 6.75" deep	\$17.90
<b>B9</b> - 9" x 3" overall size Brush for glasses up to 7" deep	\$18.90
<b>B10</b> - 10" x 3" overall size Brush for glasses up to 8.25" deep <i>For extra tall glassware!</i>	\$24.80
<b>B11</b> - 10.25" x 2.75" (flairs out to 3.75") overall size brush for Pilsners up to 8.5" deep	\$25.20
<b>BC</b> - 10" x 6" overall size Brush for coffee pots / beer pitchers	\$25.00
<b>BSET</b> - Set of four B7 and one B8 brushes as standard in retail display box	\$79.00
<b>MB2P</b> - Two post manual brush	\$26.90
<b>MB3P</b> - Three post manual brush	\$32.90
<b>MBR</b> - Replacement brush for most screw style manual brushes	\$11.40

Rigid rubber base secures to the bottom of your bar sink. Extra tall brushes cleans to the bottom of a glass that's 7" deep.

Phone: (800) 526-5278  
 US Fax: (800) 457-5612

**NEW #'s**



info@glass-pro.com  
 www.glass-pro.com

MODEL AA

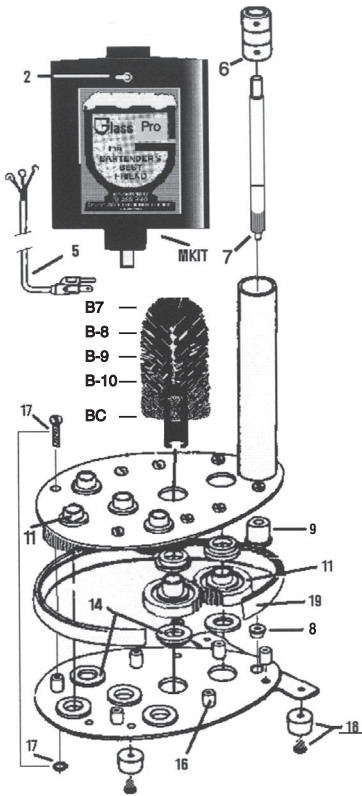

PART#	DESCRIPTION	LIST
2	SWITCH ASSEMBLY FOR AA	\$18.10
2A	SWITCH ASSEMBLY (INCL. COVER & CONNECTORS) FOR AA-SUB	\$19.10
3	SWITCH & BOX ASSEMBLY FOR AA-SUB	\$38.40
5	MOTOR CORD/PLUG ASSEMBLY FOR AA	\$19.40
5GF	MOTOR CORD COMPLETE w/GFCI FOR (Old Style) AA-SUB	\$116.60
25GF	MOTOR CORD COMPLETE w/GFCI FOR NEWER AA-SUB	\$123.00
6	COUPLER FOR AA	\$21.10
7	DRIVE SHAFT FOR AA	\$70.00
7S	PINION GEAR ASSEMBLY FOR AA-SUB	\$28.10
8 & 9	DRIVE SHAFT BUSHING SET FOR AA	\$12.60
11	BRUSH DRIVE GEAR	\$11.50
11 SET	BRUSH DRIVE GEAR SET (6)	\$63.50
14	GEAR BUSHING	\$8.80
16	COLUMN - WHITE	\$2.60
16A	COLUMN - BLACK	\$2.60
17	SCREW/LOCK NUT ASSEMBLY FOR WHITE BACK COLUMN	\$5.50
18 SET	FEET SET (4 with screws)	\$13.60
19	GEAR GUARD/BUMPER	\$27.10
GKIT	BASE REBUILD KIT FOR ALL GLASS PRO & HAMILTON BEACH WASHERS <i>Rebuild your glass washer base plates with all new parts, adding years of use to your current glass washer. Includes all applicable gears, bushings, feet etc.</i>	\$138.00

FOR AA or AA-Sub

MODEL AA-SUB

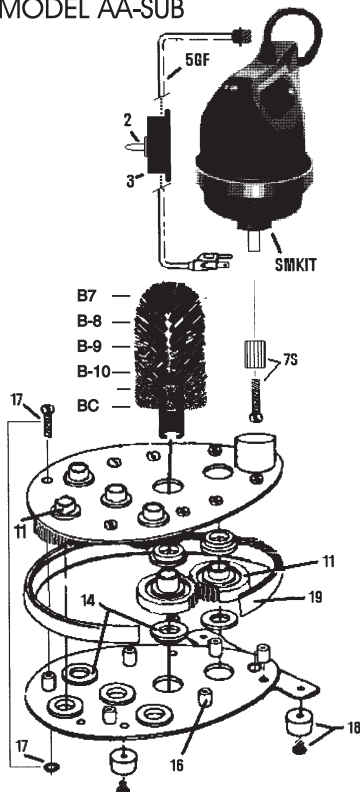

AA-BASE	COMPLETE ASSEMBLED BASE FOR MODEL AA	\$194.00
<i>Complete replacement Glass Washer bases.</i>		
<i>For Model AA just add your existing Upright Motor, Drive Shaft, and Brushes. A new Coupler (part #6) is included.</i>		
<i>For Model AA-SUB, just add your existing Submersible Motor, Shaft Pinion Gear Assembly, and Brushes.</i>		
<i>All wearing parts are new. Reconditioned stainless steel frame plates with slight cosmetic flaws may be used. One year Warranty on parts.</i>		
AA-SUB-BASE	COMPLETE ASSEMBLED BASE FOR MODEL AA-SUB	\$194.00
MKIT	MOTOR ASSEMBLY FOR AA	\$250.10
SMKIT	MOTOR ASSEMBLY FOR AA-SUB	\$368.90
<i>Motor assemblies come ready to mount with cord, switch, labeling and mounting screws included.</i>		
GFPLUG	GROUND FAULT PLUG	\$60.40





## LoSUDS & Sanitizer

Item No	Product Description	Shipping Weight	Quantity	List Price Unit	List Price Carton
DET-200	<b>LoSUDS</b> – The ultimate detergent. For electric Glass Washers – use only 1 ounce per 3 gallons of water	37 lbs. Case	Case of 4 Gallons	14.20 per Gallon	56.80 Case
DIS-201	<b>Bar Maid Quaternary Tablet Sanitizer.</b> Kitchen and Bar, 3rd sink & surface. One Tablet per gallon – 150 tablets per bottle (12 cases per master carton)	49 lbs. Master Carton	Case of 6 bottles	47.40 per Case	568.80 Master Carton/12 Cs.
DIS-202	<b>Bar Maid Sanitizer Test Strips - Quaternary Strips</b> Convenient dispenser stops wet fingers from damaging unused strips. Approximately 100 test strips per dispenser (12 dispensers per display box)	1 lb. Box	Box of 12 dispensers	9.30 per Dispenser	111.60 Box of 12
DIS-302	<b>Bar Maid Sanitizer Test Strips - Chlorinated Strips</b> Convenient dispenser stops wet fingers from damaging unused strips. Approximately 100 test strips per dispenser (12 dispensers per display box)	1 lb. Box	Box of 12 dispensers	6.30 per Dispenser	75.60 Box of 12
TAP-CAP	<b>Beer Tap Cap</b> – Keeps bugs out and helps keep taps more sanitary.	2 lbs. Case	Bag of 12	10.80 per Bag	64.80 Case (6 Bags)
TAP-STRIP	<b>Beer Drip Tray Sanitizer Strip</b> – helps eliminate food source for fruit flies. Eliminates odors and drain clogs from bacteria build up.	2 lbs. Case	Bag of 1	7.20 per Bag	86.40 Case (12 Bags)



KPC-100



DOL-100



## Keg & Pail Cart & Dolly

Item No	Product Description	Shipping Weight	Quantity	List Price Each
KPC-100	<b>KP CART</b> - Keg & Pail Cart. Easily moves heavy kegs, stock pots, 5 gallon pails etc.	20 lbs.	1 per box	269.00
DOL-100	<b>KP DOLLY</b> - Keg & Pail Dolly. Heavy duty all metal construction moves beer kegs and most sizes of trash cans. Supports up to a maximum of 400lbs.	7 lbs.	1 per box	98.00



## Glass Washer - Pre-Scrubber

Item No	Product Description	Shipping Weight	Quantity	List Price Each
GWM-1	<b>PRE-SCRUBBER</b> - Manual Glass Washer. Easily removes lipstick etc. before glasses go in cabinet washer. Also can be used as back up Glass Washer.	2 lbs.	1 per box	54.00

# Bar Maid Corporation - Glass Pro Products

2950 N.W. 22nd Terrace • Pompano Beach, FL 33069-1045

Tel: (954) 960-1468 • Fax: (954) 960-1647 • email: info@barmaidwashers.com

# Dealer Price List Prices Effective January 1, 2009



## Blenders



**BLE-100**



**BLE-200**

Item No	Product Description	Shipping Weight	List Price Each
<b>BLE-100</b>	<b>1 HP Bar Blender- 110 - 130V - 50/60Hz</b> Features powerful 2 speed motor, stackable, virtually unbreakable 48 oz. polycarbonate container with heavy duty stainless ball bearing blade assembly.	8 Lbs	196.00
<b>BLE-1-11606</b>	<b>48 oz. Blender Container -</b> Replacement, Includes blade assembly, collar and lid.	3 Lbs	59.60
<b>BLE-1-11606SS</b>	<b>32 oz. Stainless Steel Blender Container -</b> Includes blade assembly, collar and lid.	3 Lbs	92.00
<b>BLE-1-9006</b>	<b>Container Silicone Seal -</b> Replacement.	.1 Lbs	1.60
<b>BLE-1-4006A</b>	<b>Stainless Blade Assembly -</b> Replacement, includes nut, holder, ball bearing and silicone seal.	.5 Lbs	39.00
<b>BLE-1-6006A</b>	<b>Stainless Blade -</b> Replacement, includes nut.	.3 Lbs	9.40
<b>BLE-1-16006</b>	<b>Clutch -</b> Replacement.	.3 Lbs	3.90
<b>BLE-200</b>	<b>2 HP Bar Blender- 110 - 130V - 50/60Hz</b> Features powerful "Smart" motor that automatically adjusts speed, Touch Pad controls and virtually unbreakable 64 oz. polycarbonate container with heavy duty stainless steel ball bearing blade assembly	13 Lbs	544.00
<b>BLE-2-3008A</b>	<b>64 oz. Blender Container -</b> Replacement Including blade assembly and lid.	3.5 Lbs	119.20
<b>BLE-2-4008A</b>	<b>Clutch -</b> Replacement assembly.	.5 Lbs	8.00

### Freight Policy

**PLEASE NOTE:** Pre-paid freight applies to shipment weight only and not to other services. Charges levied by carriers for delivery appointments, driver assistance, etc., are the responsibility of the purchaser.

**100% freight paid** - on orders of 6 Electric Glass Washers (any mix) or 18 Blenders (any mix) OR any combination of Glass Washers, Blenders, KP Carts, Dollys, Manual Glass Washers, Pre-Scrubbers, and/or Test Strips for a combined dollar volume of minimum \$1950.00 (shipped within the contiguous USA).

**50% Freight paid** - on orders of at least 3 Electric Glass Washers (any mix) or at least 9 Blenders (any mix).

**Replacement parts** - have no freight allowance **EXCEPT** when accompanying orders already entitled to 100% freight prepaid.

**Lo Suds & Sanitizer** - Lo Suds cases and Sanitizer Master Cartons mix or match - 25% paid on 25 - 75 cases, 50% paid on 76+ cases - shipped within the contiguous USA.

### Warranty

**Glass Pro** products feature a 12 month from user purchase warranty on parts and labor for assembly or material defect.

Optional 2-year warranty is available at time of warranty registration at a cost of \$25.00. **Glass Pro** is a division of Bar Maid Corporation.

**Blenders** are covered by a one year "limited" warranty on the blender base covering defects in materials, workmanship and/or electrical components

Containers including wearing parts, blades, clutches and container drives are not covered. For claims, call Bar Maid Warranty Service at 1-866-531-6243.

See [www.barmaidwashers.com](http://www.barmaidwashers.com) for complete details.

### DEALER PRICING

Prices are subject to change without notice.

Minimum order size is \$30.00.

Parts orders are FOB Pompano Beach, FL.

Pre-paid freight applies to shipment weight only and not to other services.

Charges levied by carriers for delivery appointments, driver assistance, etc., are the responsibility of the purchaser.



ETL Listed

ALL MODELS TESTED AND APPROVED FOR SAFETY AND SANITATION IN THE USA AND CANADA  
ANSI/JUL 921 CSA C22.2 NO 168M NSF-26

